

## Replacing the arm cuff cover

Front

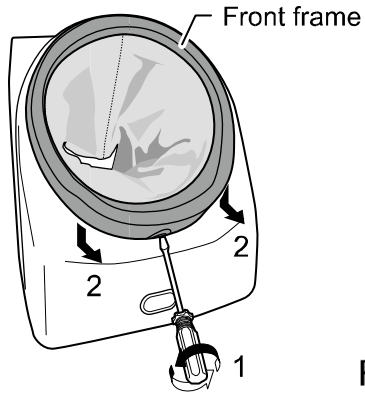

1. Use a flathead screwdriver to loosen the screw.
2. Slide the front frame down, and then pull forward.

3. Loosen the screws (armrest securing screws) on the rear side

Rear

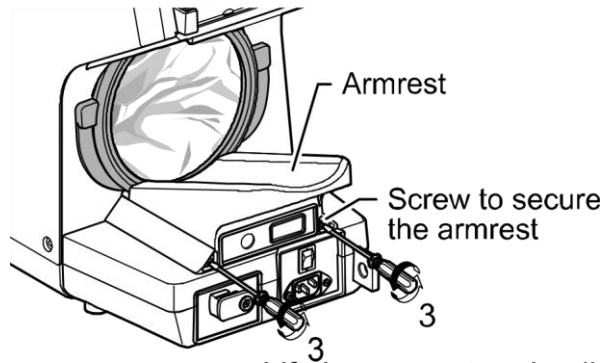

- (armrest securing and remove the screws.

4. Lift the armrest and pull back.

Rear

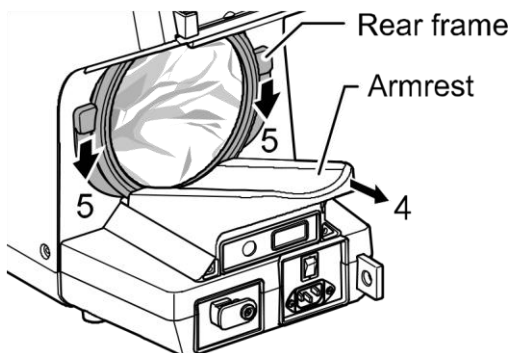

5. Slide the rear frame down, then pull out.

Rear

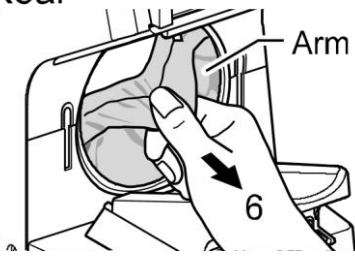

6. Pull the arm cuff cover out from the vinyl ring groove to

remove.

Rear

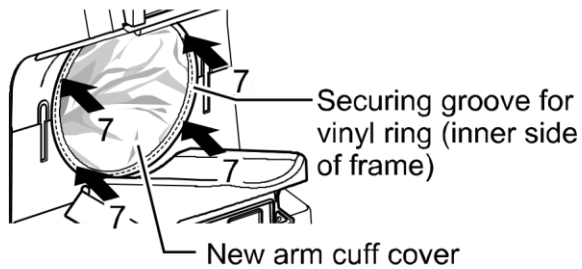

7. Insert the new arm cuff cover and push the vinyl ring into the groove (on the inner side of the frame) to attach.

Front

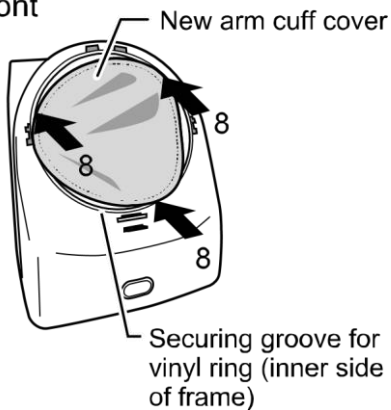

8. Fit the new arm cuff cover over the front vinyl ring groove.

9. Reversing the steps used to remove, reattach the rear and front frames, return the armrest to its original position, then replace the armrest securing screws (2) and front frame screw (1).

#### Note

- The arm cuff cover is consumable. New covers must be purchased separately.



3A Oaklands Business Centre  
Oaklands Park  
Wokingham  
RG41 2FD

Tel: 01628 773233

<http://www.pmsinstruments.co.uk>  
email:sales@pmsinstruments.co.uk

